



COPd-6™ COPD Screener



Quick Start Guide

Prepare Device

- 1 ① Switch On.



- 2 Set test subject's age.

Press ▲ or ▼
to change age.



Press ← to set.

- 3 Set test subject's height in inches.

Press ▲ or ▼
to change height.



Press ← to set.

- 4 Set test subject's gender.

Press ▲ or ▼
to change gender.



Press ← to set.

- 5 Set test subject's population group.

Press ▲ or ▼
to change
population group.



Press ← to set.

Letter	Population Group	Ref
c	Caucasian	NHANES III
AA	African-American	NHANES III
HA	Mexican-American	NHANES III

Perform Test

- 1 Insert disposable SafeTway mouthpiece.

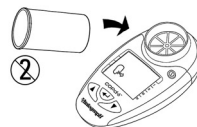

- 2 Demonstrate to test subject.

- ▼ Fully breathe in, hold ...
- ▼ Insert and lightly bite the mouthpiece
- ▼ Then blow as hard as possible for 6 seconds



- 3 Repeat blow 2 more times.

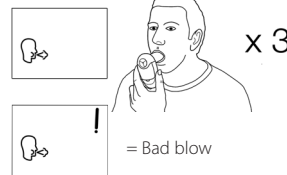

- 4 Press ← to show best test

Test Result

Normal

Arrows always
show best test ...



Negative:

- ▼ Spirometry not required
- ▼ COPD classification green

Possible COPD

Arrows always
show best test ...



Positive:

- ▼ refer for spirometry
- ▼ COPD classification I to IV

Possible restriction

Arrows always
show best test ...



Obstructive Index Low:

- ▼ refer for spirometry
- ▼ COPD not likely

View Parameters

- 1 Display shows FEV1 and % of predicted.

Displays numbers
for each blow
until ←
pressed ...



- 2 Press ▲ to show FEV6, FEV1/FEV6 ratio, % of predicted and estimated Lung Age.



- 3 ① for 3s to switch off.

Cleaning and disinfecting

The outer surfaces should be cleaned every week, more often if necessary. The use of a disposable disinfecting wipe is recommended, with special attention to the mouthpiece area.